

Spring Cable Reels

Stock&Go







Spring cable reels
Stock&Go
on a rail mounted
mobile crane

You make the first move *Stock&Go*

- fine graded cable reel sizes
- manifold applications for indoor and outdoor use
- cable installed and connected
 - sense of unwinding left
- lead time within one week

– these are the Wampfler spring cable reels *Stock&Go*.

Use of *Wampfler cable RXP-8* – best choice for high mechanical stress in reeling applications because of lay out and quality!

Spring cable reels *Stock&Go* are suitable for:

- machine and plant construction
- port applications
- steel factory plants
- theater and stage applications
- waste water treatment plants
- ...



Spring cable reel
Stock&Go
on a spreader



Stock&Go:
fast, safe, straight forward!



Stock&Go:
one product line -
hundreds of
applications

Maximum safety
because of patented
spring cassettes



Spring Cable Reel *Stock&Go* *All around sophisticated*



Optimal corrosion protection even in aggressive atmosphere – side shields made of galvanized steel, drum body powder coated

Undisturbed operation at high durability because of high-grade double sided ball bearings

For high duty cycle,
– springs made of high quality spring steel

Change of sense of rotation – simple and safe, the springs are safely integrated in cassettes

Minimum cable reel dimensions due to application of the optimal cable with lowest outer diameter

Cable for highest mechanical stress

Wampfler cable RXP-8

especially developed for reeling applications, high maximum admissible tensile load, abrasion-resistant, halogen free

Assured operation with standardised slip ring body in rigid plastic housing (up to 47 A at 100% ED and 1000 V)

Reliable Standard!
High durability due to low
abrasion on the brushes and
high abrasion-resistant rings

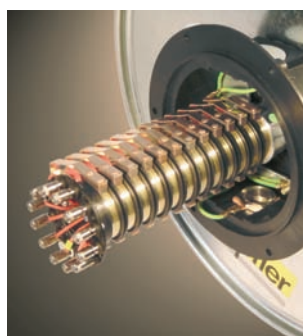

Dimensions & Accessories

Flange Type

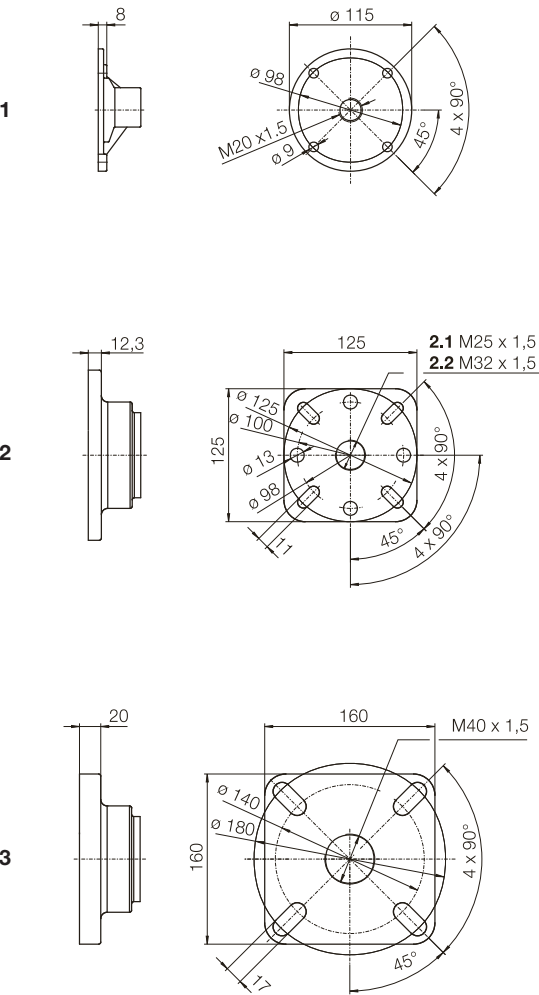

Geometry

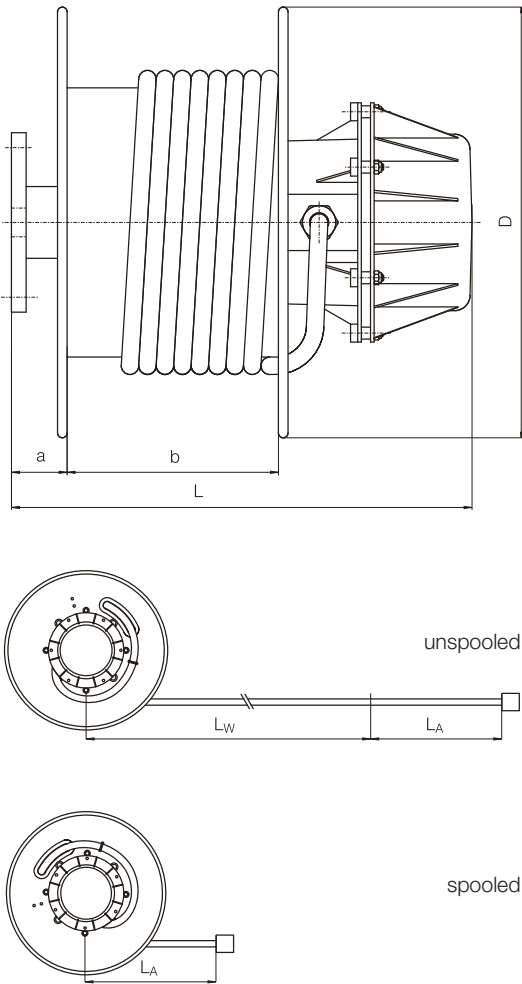

| Designation | Lay out | Order-Number | | Description |
|-----------------|---------|--------------|---------|--|
| Cable mesh grip | | A | 1036969 | The ideal tension relief for cable at the feeding point – safe and simple in handling. The flexible wire netting is guiding the appearing forces on a long part of the outer jacket. Therefore a punctual clamping can be avoided. |
| | | B | 1036970 | |
| Roller guide | | | 1018356 | The optimal solution for a well defined guidance of the cable. For example the lay down of the cable in a chamfer. |

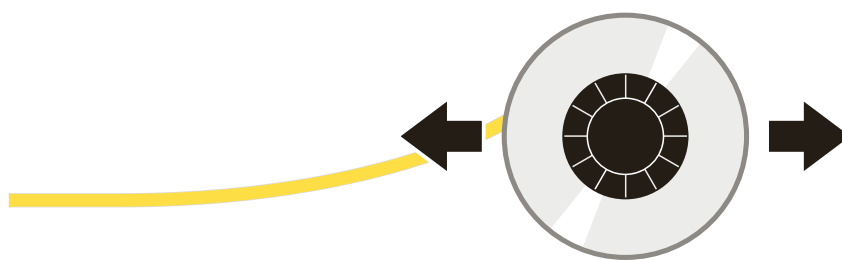

Horizontal Application

| Cable cores x [mm²] | Winding l. L _w [m] | Inact. installation length [m] | Order-Number | D [mm] | L [mm] | b [mm] | a [mm] | Flange type | U _{max} [V] | I _{max} ^{†1} [A] | Mesh grip |
|------------------------|----------------------------------|-----------------------------------|--------------|-----------|-----------|-----------|-----------|----------------|-------------------------|---------------------------------------|--------------|
| 4 x 2,5 | 8 | 1,5 | SGR01 | 280 | 295 | 95 | 48 | 1 | 415 | 25 | A |
| | 18 | | SGR02 | | | | | | | | |
| | 28 | | SGR11 | 46 | 2.1 | | | | | | |
| | 37 | | SGR30 | | 2.2 | | | | | | |
| | 47 | | SGR50 | | | | | | | | |
| 7 x 1,5 | 8 | 1,5 | SGR03 | 280 | 405 | 95 | 46 | 1 | 415 | 16 | A |
| | 18 | | SGR12 | 430 | 466 | 200 | | 2.1 | | | |
| | 28 | | SGR14 | | | | | | | | |
| | 37 | | SGR31 | | | | | | | | |
| | 47 | | SGR51 | 550 | 501 | 235 | | | | | |
| 7 x 2,5 | 8 | 1,5 | SGR04 | 280 | 405 | 95 | 46 | 1 | 415 | 25 | A |
| | 18 | | SGR15 | 430 | 466 | 200 | | 2.1 | | | |
| | 28 | | SGR17 | | | | | | | | |
| | 37 | | SGR33 | | | | | | | | |
| | 47 | | SGR52 | 550 | 501 | 235 | | | | | |
| 12 x 1,5 | 8 | 1,5 | SGR70 | 385 | 466 | 160 | 46 | 2.1 | 415 | 16 | B |
| | 18 | | SGR18 | 430 | 506 | 200 | | | | | |
| | 28 | | SGR19 | | | | | 460 | | | |
| | 37 | | SGR35 | | | | | | | | |
| | 47 | | SGR62 | 550 | 541 | 235 | | | | | |
| 12 x 2,5 | 8 | 1,5 | SGR71 | 385 | 466 | 160 | 46 | 2.1 | 415 | 25 | B |
| | 18 | | SGR20 | 430 | 506 | 200 | | | | | |
| | 28 | | SGR37 | 460 | 526 | 220 | | 2.2 | | | |
| | 37 | | SGR54 | 550 | 541 | 235 | | | | | |
| | 47 | | SGR55 | | | | | | | | |
| 18 x 1,5 | 8 | 1,5 | SGR72 | 385 | 556 | 160 | 46 | 2.1 | 415 | 16 | B |
| | 18 | | SGR21 | 430 | 596 | 200 | | | | | |
| | 28 | | SGR22 | | | | | 460 | | | |
| | 37 | | SGR39 | | | | | | | | |
| | 47 | | SGR56 | 550 | 631 | 235 | | | | | |
| 18 x 2,5 | 8 | 1,5 | SGR73 | 385 | 556 | 160 | 46 | 2.1 | 415 | 25 | B |
| | 18 | | SGR23 | 430 | 596 | 200 | | | | | |
| | 28 | | SGR40 | 460 | 616 | 220 | | 2.2 | | | |
| | 37 | | SGR57 | 550 | 631 | 235 | | | | | |
| | 47 | | SGR58 | | | | | | | | |
| 4 x 4 | 8 | 1,5 | SGR05 | 280 | 405 | 95 | 46 | 1 | 1000 | 30 | B |
| | 18 | | SGR24 | 430 | 506 | 200 | | 2.1 | | | |
| | 28 | | SGR26 | | | | | | | | |
| | 37 | | SGR42 | 460 | 526 | 220 | | 2.2 | | | |
| | 47 | | SGR59 | 550 | 541 | 235 | | | | | |
| 4 x 6 | 8 | 1,5 | SGR74 | 385 | 466 | 160 | 46 | 2.1 | 1000 | 47 | B |
| | 18 | | SGR27 | 430 | 506 | 200 | | | | | |
| | 28 | | SGR28 | | | | | 460 | | | |
| | 37 | | SGR44 | | | | | | | | |
| | 47 | | SGR61 | 550 | 541 | 235 | | | | | |

Cable type: Wampfler cable RXP-8

^{†1} max. amperage at complete unspooled cable and 3 loaded conductors. All other loads need to be verified according to the applicable national and international standards

Vertical Application

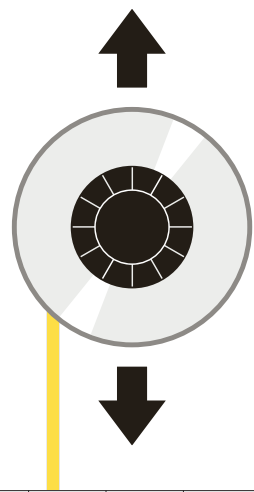

| Cable cores x [mm²] | Winding l. ^[2] L _w [m] | Inact. installation length [m] | Order-Number | D [mm] | L [mm] | b [mm] | a [mm] | Flange type | U _{max} [V] | I _{max} ^[1] [A] | Mesh grip |
|------------------------|---|-----------------------------------|--------------|-----------|-----------|-----------|-----------|----------------|-------------------------|--|--------------|
| 4 x 2,5 | 8 | 1,5 | SGR01 | 280 | 295 | 95 | 48 | 1 | 415 | 25 | A |
| | 17 | 2,5 | SGR02 | | | | | 1 | | | |
| | 23 | 1,5 | SGR10 | 430 | 406 | 200 | 46 | 2.1 | | | |
| | 28 | | SGR11 | | | | | | | | |
| | | | | | | | | | | | |
| 7 x 1,5 | 8 | 1,5 | SGR03 | 280 | 405 | 95 | 48 | 1 | 415 | 16 | A |
| | 18 | | SGR12 | 430 | 466 | 200 | 46 | 2.1 | | | |
| | 23 | | SGR13 | | | | | | | | |
| | 28 | | SGR14 | | | | | | | | |
| | | | | | | | | | | | |
| 7 x 2,5 | 8 | 1,5 | SGR04 | 280 | 405 | 95 | 48 | 1 | 415 | 25 | A |
| | 18 | | SGR15 | 430 | 466 | 200 | 46 | 2.1 | | | |
| | 21 | | SGR16 | | | | | | | | |
| | 27 | | SGR32 | 460 | 486 | 220 | | | | | |
| | | | | | | | | | | | |
| 12 x 1,5 | 8 | 1,5 | SGR70 | 385 | 466 | 160 | 46 | 2.1 | 415 | 16 | B |
| | 18 | | SGR18 | 430 | 506 | 200 | | 2.2 | | | |
| | 23 | | SGR34 | 460 | 526 | 220 | | | | | |
| | 26 | | SGR53 | 550 | 541 | 235 | | | | | |
| | | | | | | | | | | | |
| 12 x 2,5 | 8 | 1,5 | SGR71 | 385 | 466 | 160 | 46 | 2.1 | 415 | 25 | B |
| | 17 | | SGR36 | 460 | 526 | 220 | | 2.2 | | | |
| | 22 | | SGR80 | 550 | 541 | 235 | | | | | |
| | 27 | | SGR90 | 650 | 667 | 252 | 63 | 3 | | | |
| | | | | | | | | | | | |
| 18 x 1,5 | 8 | 1,5 | SGR72 | 385 | 556 | 160 | 46 | 2.1 | 415 | 16 | B |
| | 17 | | SGR38 | 460 | 616 | 220 | | 2.2 | | | |
| | 22 | | SGR81 | 550 | 631 | 235 | | | | | |
| | 27 | | SGR91 | 650 | 667 | 252 | 63 | 3 | | | |
| | | | | | | | | | | | |
| 18 x 2,5 | 8 | 1,5 | SGR73 | 385 | 556 | 160 | 46 | 2.1 | 415 | 25 | B |
| | 18 | | SGR82 | 550 | 631 | 235 | | 2.2 | | | |
| | 22 | | SGR83 | | | | | | | | |
| | 27 | | SGR92 | 650 | 667 | 252 | 63 | 3 | | | |
| | | | | | | | | | | | |
| 4 x 4 | 8 | 1,5 | SGR05 | 280 | 405 | 95 | 48 | 1 | 1000 | 30 | B |
| | 18 | | SGR24 | 430 | 506 | 200 | 46 | 2.1 | | | |
| | 23 | | SGR25 | | | | | | | | |
| | 28 | | SGR41 | | | | | | | | |
| | | | | | | | | | | | |
| 4 x 6 | 8 | 1,5 | SGR74 | 385 | 466 | 160 | 46 | 2.1 | 1000 | 47 | B |
| | 18 | | SGR27 | 430 | 506 | 200 | | 2.2 | | | |
| | 22 | | SGR43 | 460 | 526 | 220 | | | | | |
| | 25 | | SGR60 | 550 | 541 | 235 | | | | | |

^② with freely suspending connecting cable as well as auxiliary weights the winding length is possibly reduced

www = wampfler world wide

*The easy way:
www.wampfler.com*

Wampfler AG

Rheinstrasse 27 + 33
79576 Weil am Rhein
Germany

Customer Support

Phone +49 (0) 7621/66 22 22

Phone +49 (0) 7621/6 62-0

Fax +49 (0) 7621/6 62-144

info@wampfler.com

www.wampfler.com



solutions for a moving world